

FACING AMENITIES

FACING M.H. DEL PILAR STREET

FACING 2ND STREET

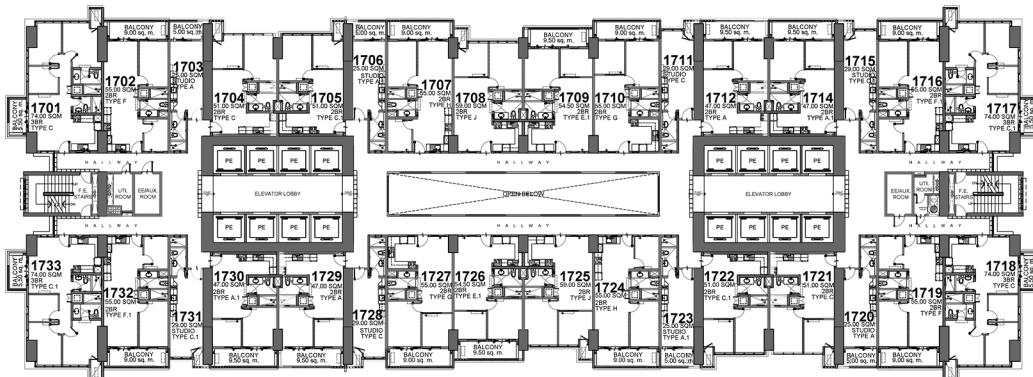

FACING 10TH AVENUE

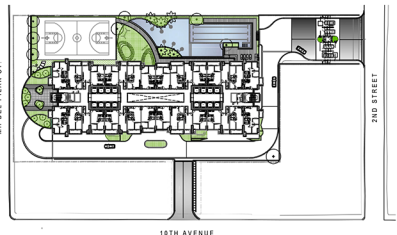

www.thecalineatower.com/floor-plans

LIST OF POSSIBLE TANDEM UNITS:

- 1707 & 1708
- 1709 & 1710
- 1724 & 1725
- 1726 & 1727

NOTE:

Standard company policy regarding request for tandem shall apply.



17TH FLOOR PLAN

JANUARY 2023

PER MEMO REF. # DE-23-01-008



APPROVED BY:	Phipay	SPW	1/11/23
	Nikko	SW	1/11/23
	Ana	SW	1/11/23



Disclaimer: Floor plans depicted in this material are for demonstration purposes only and should not be relied upon as final project plans. For announcement purposes only.

AVAILABILITY PLAN